

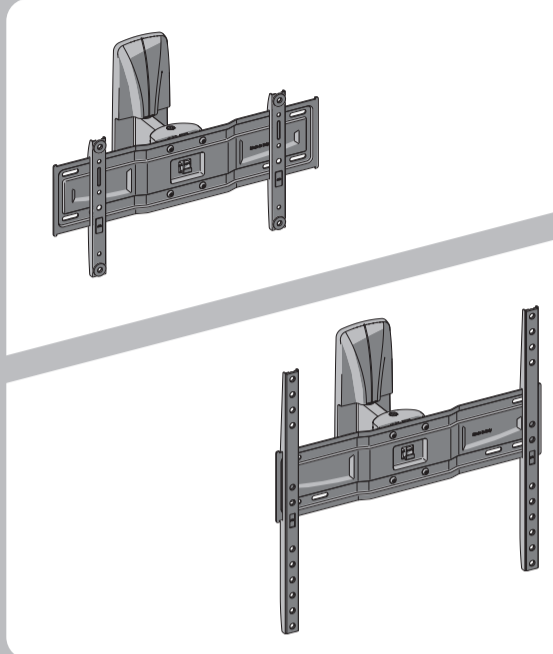

# EXTRA 400 DUO

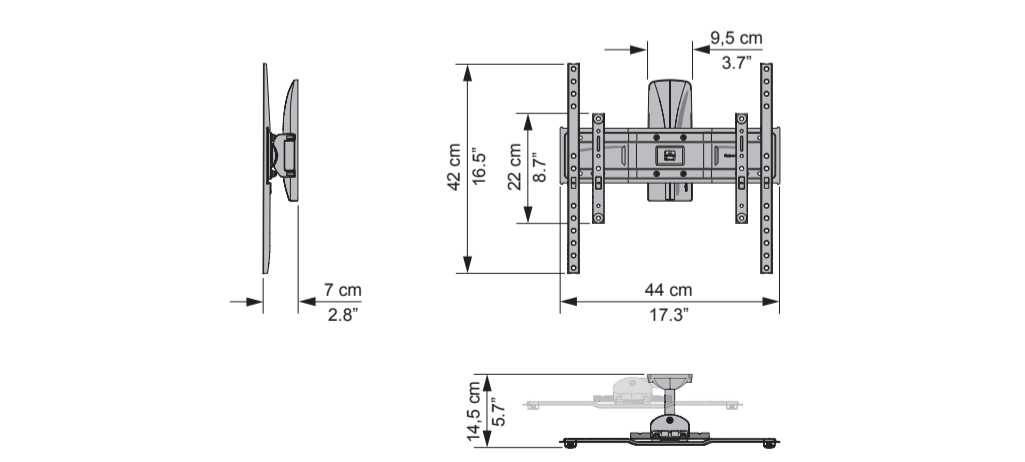

IT ISTRUZIONI DI MONTAGGIO  
FR INSTRUCTIONS DE MONTAGE  
EN MOUNTING INSTRUCTIONS  
DE MONTAGEANLEITUNG  
NL MONTAGEVOORSCHRIFT  
ES GUÍA DE MONTAJE  
PT INSTRUÇÕES DE MONTAGEM  
PL INSTRUKCJA MONTAŻU  
CZ NÁVOD K MONTÁŽI  
RO INSTRUCȚIUNI DE MONTARE  
HU SZERELÉSI ÚTMUTATÓ  
FI ASENNUSOHJEET  
SK NÁVOD NA MONTÁŽ  
SL NAVODILA ZA MONTAŽO  
MK ИНСТРУКЦИЈА ЗА МОНТАЖА  
SQ UDHËZIME PËR MONTIMIN

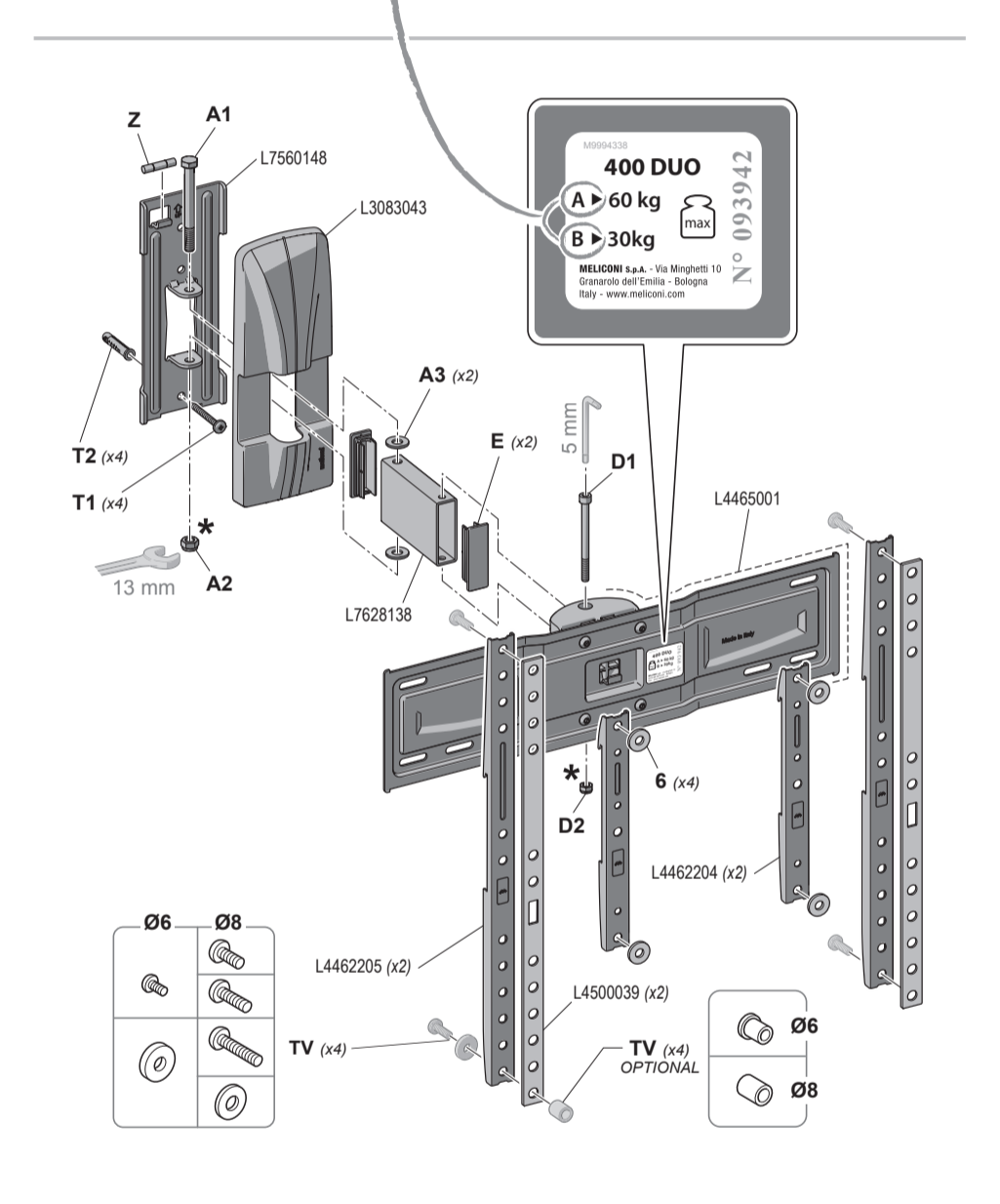
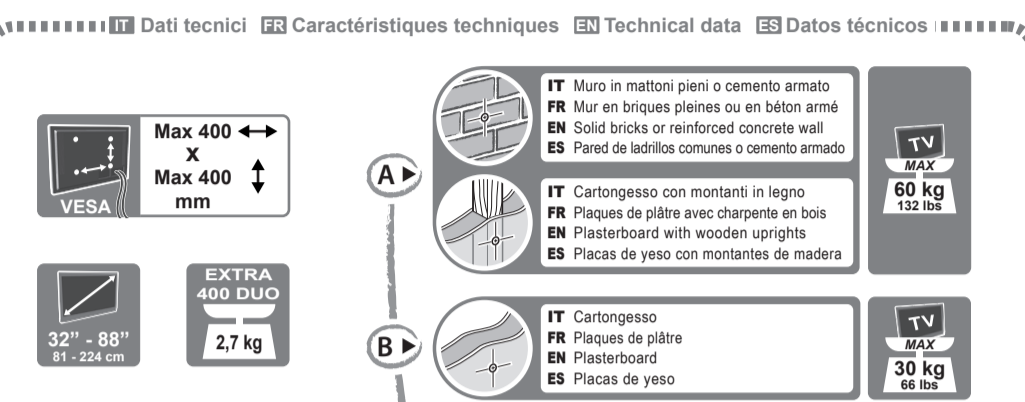
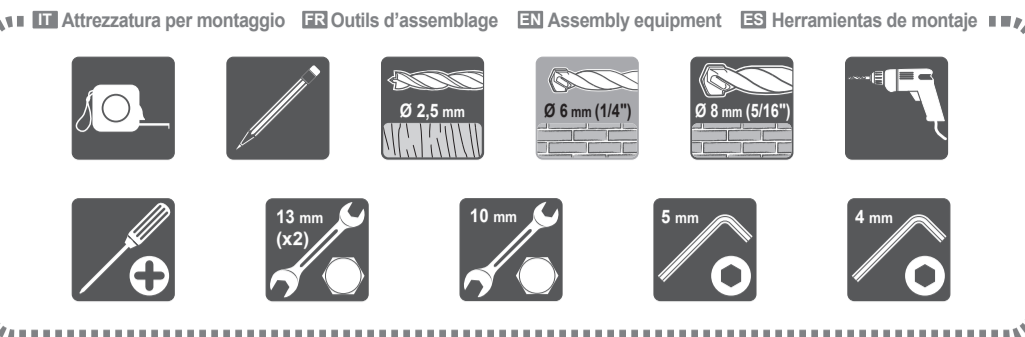

\* IT Dado autobloccante, specifico per evitare svitamenti accidentali. Avvitare in maniera decisa, con gli appositi attrezzi, anche dopo aver avvertito la prima resistenza.  
FR Écrou autobloquant, conçu pour éviter tout desserrage accidentel. Serrez fermement, avec les outils appropriés, même après avoir perçu la première résistance.  
EN Self-locking nut, designed to prevent accidental loosening. Tighten firmly, with the correct tools, even after feeling the first resistance.  
ES Tuerca autobloqueante para evitar que se afloje. Enroscar a fondo con las herramientas específicas, incluso después de haber notado la resistencia inicial.

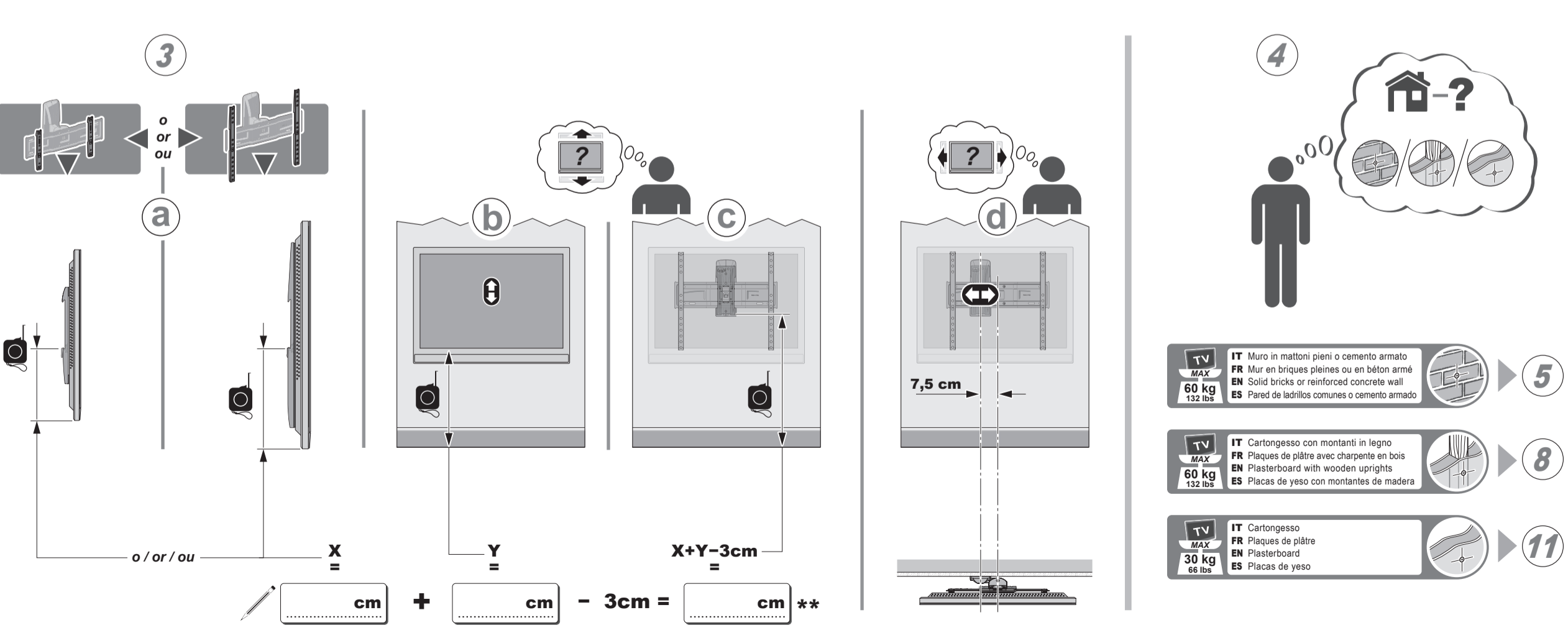
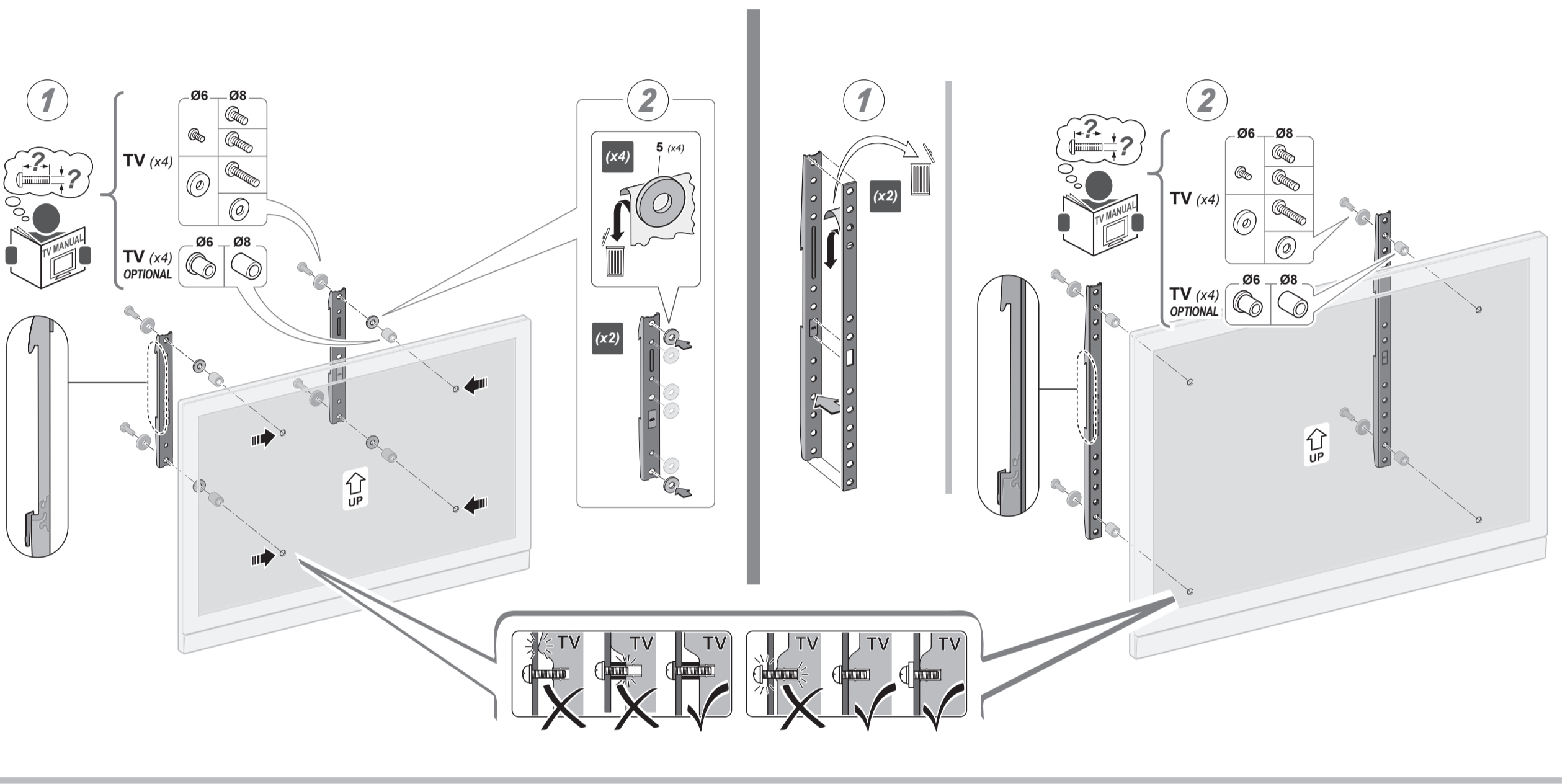
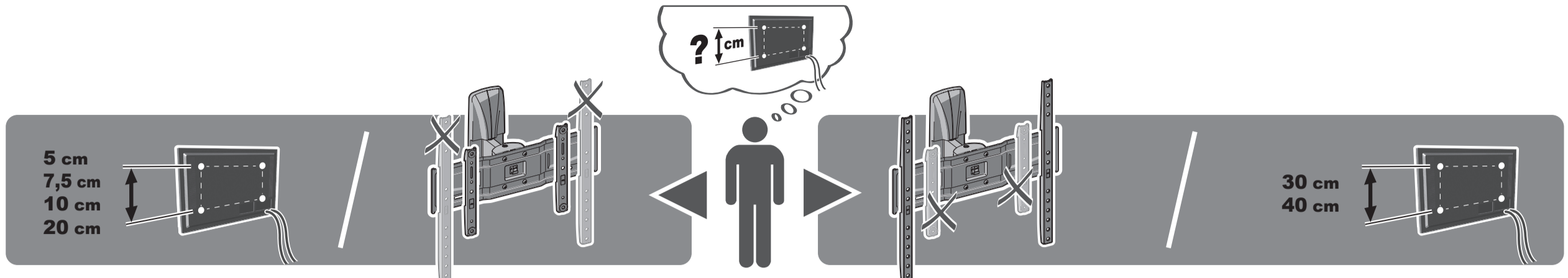
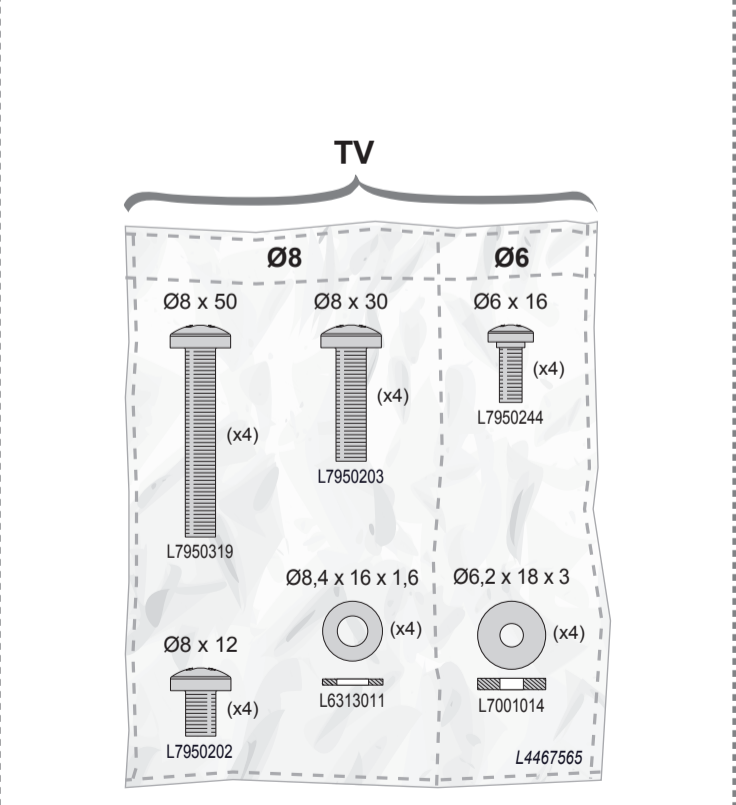
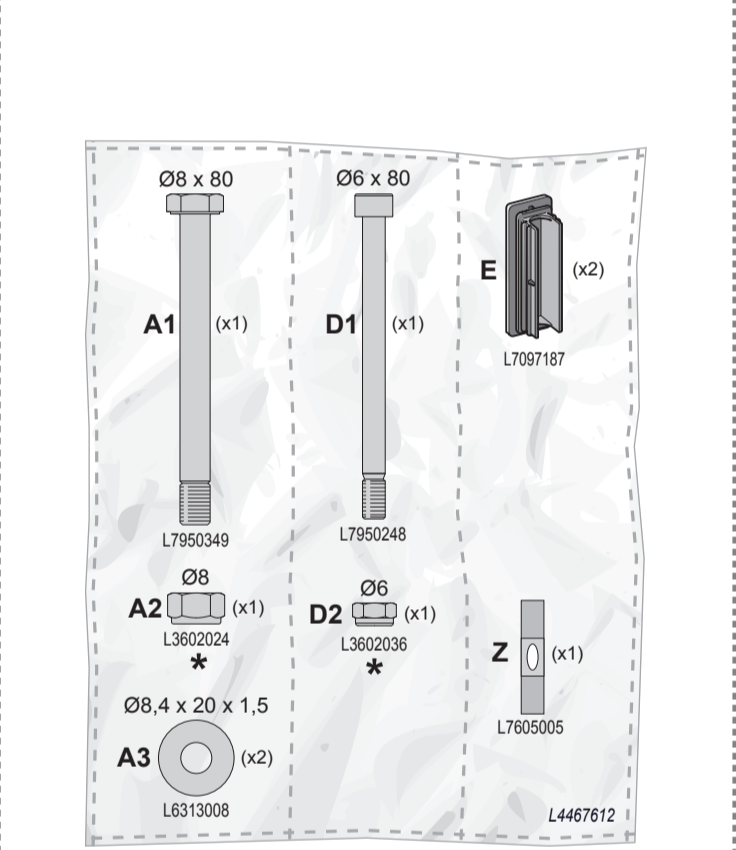
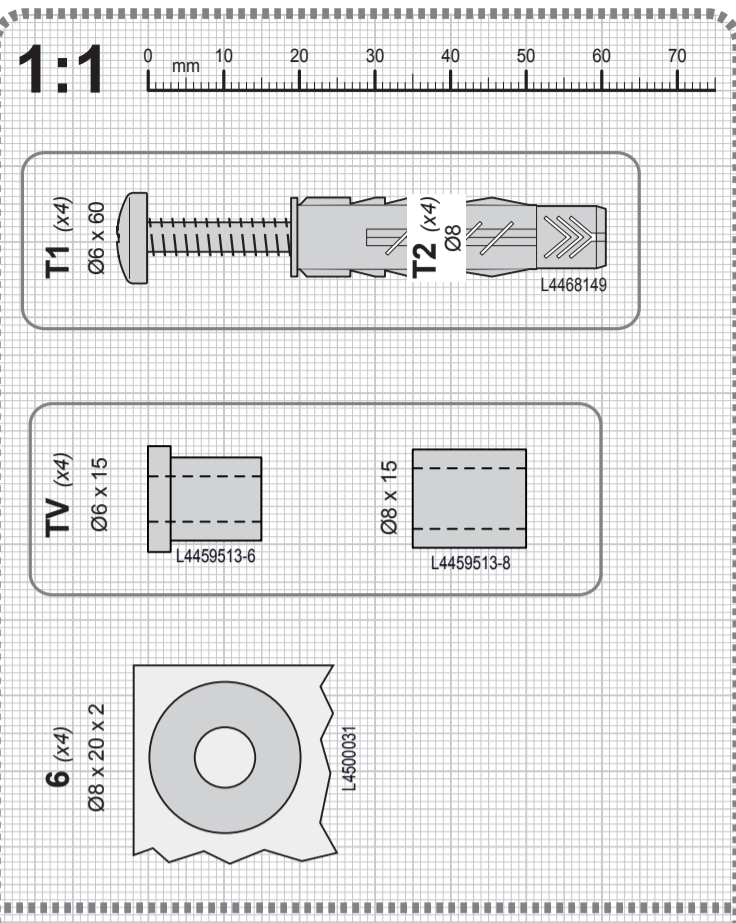

Meliconi S.p.A. - V. Minghetti, 10  
40057 Cadrano di Granarolo E. (BO) Italy  
www.meliconi.com e-mail: info@meliconi.com



